



# Noise-Lock® STC 53 Steel Acoustic Door

DATASHEET

[iac-acoustics-thailand.com](http://iac-acoustics-thailand.com)



## Data Sheet

### Noise-Lock® STC 53 Steel Acoustic Door



#### Overview

- Certified performance rating
- Manufactured to standard and custom sizes
- Available as single leaf or double door sets with glazing options
- Cam-lift hinges used to maximize acoustic seal
- Rugged steel construction
- Factory assembled and checked
- Finished in polyester powder coating as standard
- Wood veneer and powder coat finish options available
- Door leaf is 2 1/2" thick

#### Acoustic Rating

STC 53(dB) to achieve minimum NIC 48 once installed (subject to flanking).

Rw (C; Ctr) 52 (-2 ; -7) dB to achieve minimum R'w 47 dB once installed (subject to flanking). Certified laboratory performance in single leaf arrangement as follows:

Frequency (Hz)	63	80	100	125	160	200	250	315	400	500	630	800	1000	1250	1600	2000	2500	3150	4000
Noise-Lock® STC 53	22	24	27	31	42	47	47	48	50	53	54	54	54	53	51	51	53	57	58

#### Standard Features



Acoustic Rated



Easy Access  
Flat Thresholds

#### Optional Extras



Blast Resistance



RF Shielding



Fire Rated





### Overview

IAC Acoustics produces an engineered system — fully factory assembled complete with a leaf, architectural split-frame, acoustic seals, cam-lift hinges and hardware. All doors are pre-hung for operational alignment, fit and finish before shipping.

Noise-Lock® doors are laboratory-tested for performance in independent laboratories, further supported by installed site testing. IAC Acoustics is renowned for quality, durability and guarantees in-field performance.

### Hardware

IAC Acoustics Noise-Lock® doors are available with a number of standard and custom hardware options. Please contact your local IAC Acoustics office for further details.

- ① Acoustic Seal
- ② Cam-lift Hinge
- ③ Boot Seal
- ④ Sill
- ⑤ Male Frame
- ⑥ Main Frame / Female Frame

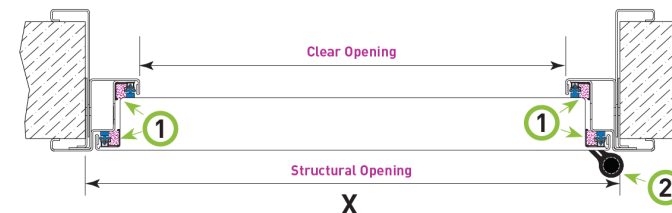
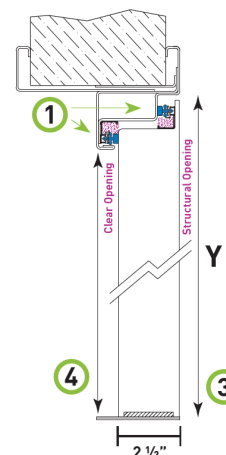

The relationship between the clear and structural openings for both width and height is the same for all sizes of Noise-Lock® STC 53 doors. An example for a 3' x 7' door can be found in the table below:

Door Opening	Width (X)	Height (Y)
Structural/Rough Opening	3'-5 1/2"	7'-3"*
Clear Opening	3'	7'

\* includes 1/4" threshold

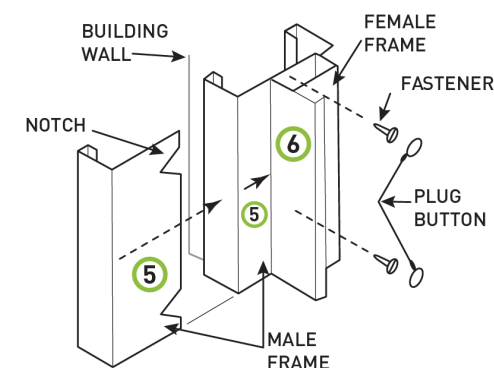

### Performance Features

- Self-aligning magnetic seals assure long life and high in-field performance, even under constant use
- Cam-lift hinges lower and seal the door to the floor eliminating the high maintenance of automatic drop seals
- Split frames eliminate in-field grouting to achieve the specified acoustic performance with quick and clean installation



**IAC Acoustics Thailand Co., Ltd.**

6/54-56, Thanon Poemsin Soi 42,

Ongern - Sai Mai Bangkok 10220 Thailand

Ph: (+66) 02-1012827 | Email: [info@iac-acoustics-thailand.com](mailto:info@iac-acoustics-thailand.com)

[iac-acoustics-thailand.com](http://iac-acoustics-thailand.com)

IAC has worldwide offices and manufacturing plants in the UK, Australia, Canada, China, Malaysia, Indonesia, Thailand, Philippines Denmark, France, Germany, Italy, Spain, UAE - Dubai, USA Houston, USA Lincoln, USA - New York.

